

notes
 this drawing and design is the copyright of aja architects llp and must not be reproduced in part or whole without prior written consent. contractors must verify all dimensions on site before commencing work or preparing shop drawings. if in doubt ask.
 where this drawing contains any Ordnance Survey mapping material, it has been reproduced under license number 100022276.
 Ordnance Survey © Crown copyright

Schedule of Accommodation	
All areas are approximate	
Proposed Building Extension	(GA) 10,944 sq m (117,800 sq ft) (GFA) 11,081 sq m (119,275 sq ft)
Modular Office First Floor	(GA) 145 sq m (1,572 sq ft) (GFA) 145 sq m (1,576 sq ft)
Gate House	(GA) 15.0 sq m (161 sq ft) (GFA) 16.5 sq m (178 sq ft)
TOTAL AREA:	(GA) 11,119 sq m (119,683 sq ft) (GFA) 11,262 sq m (121,229 sq ft)

Colour Legend:
 Extension/
 New Works

- ⊠ Fixed CCTV Camera (existing)
- ⊠ PTZ CCTV Camera (existing)
- ⊠ Fixed CCTV Camera (New)
- ⊠ PTZ CCTV Camera (New)

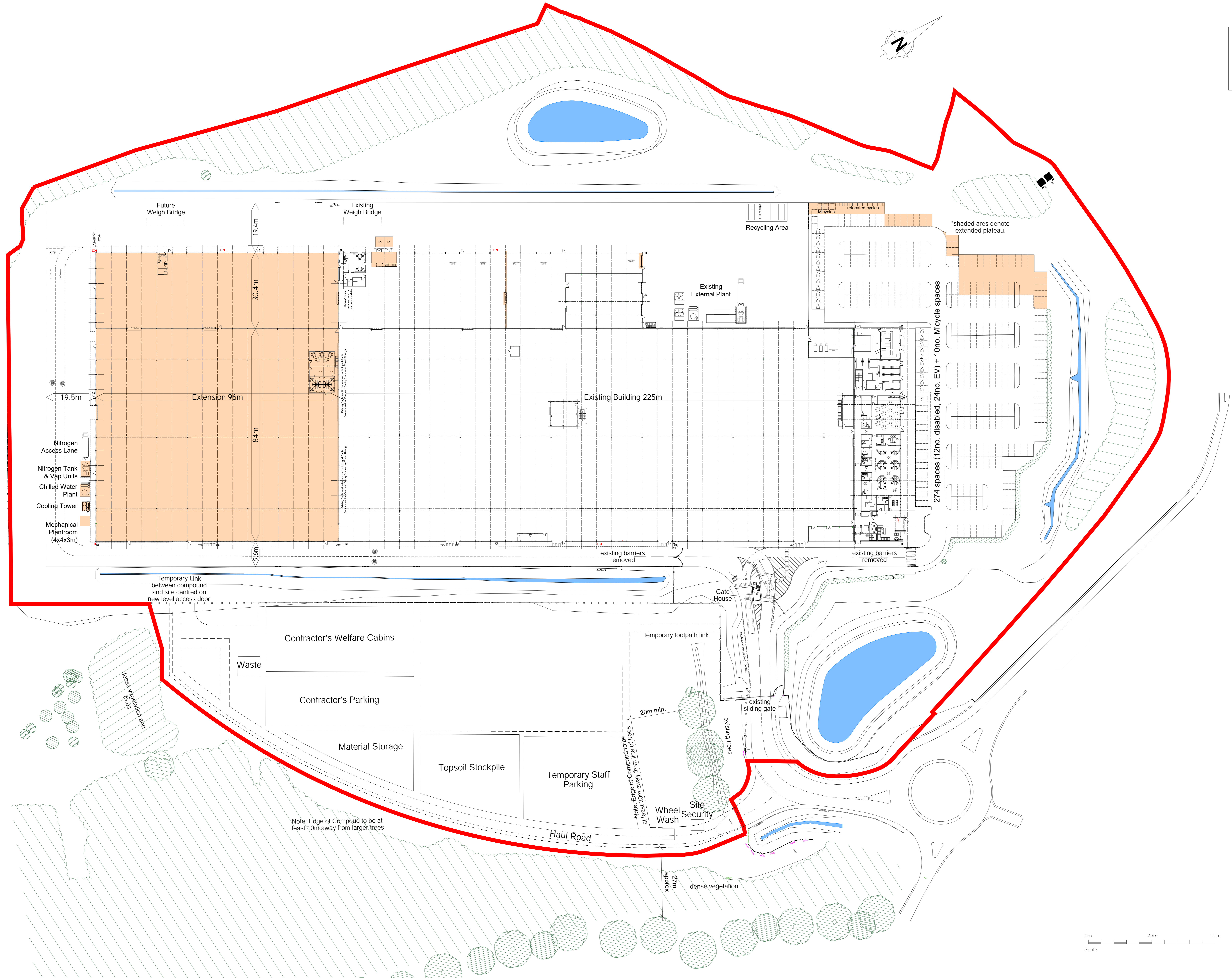

no. date revision by



aja architects llp
 1170 Elliott Court
 Herald Avenue
 Coventry Business Park
 COVENTRY CV5 6UB
 T: 024 7625 3200
 F: 024 7625 3210
 E: aja@aja-architects.com
 W: www.aja-architects.com

client:
 Magna International Holdings (UK) Limited and Rula Developments Ltd

project:
 Extension to Existing Manufacturing Plant and Associated Works

drawing:
 PROPOSED SITE PLAN

scale: 1:500@A0 drawn: rpw
 checked: spp date: 18.10.23

no.
 7262-104